

## Powerful vertical order picker, reliable and safe even at great heights.

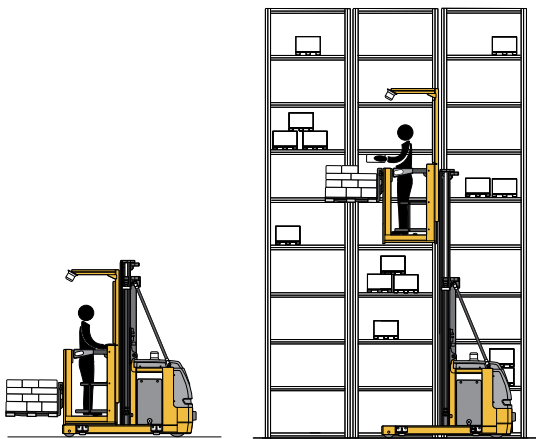

The 904 ac vertical order pickers are ideal for applications on free or guided aisles, for medium and high level order picking. The 6 kW ac traction motor, the 6 kW lift motor and the electronic control ensure manoeuvrability and power, providing the right amount of power for any type of application, even for the most intensive ones. The standard 48 V version, the comfortable operator compartment with guard and the intermediate fork lifting function ensure efficient order picking at high levels of up to 10,600 mm. The use of ac technology ensures high performance at reduced maintenance costs.

### Operator's compartment

The spacious cabin is designed for upright operation and sized to render all movements easy. All controls can be actuated from a multifunction ergonomic joystick suitably positioned for right-handed operation while the steering is ideal for left-handed operation. By opening the lateral doors you will also cause the feet guards to open upwards, allowing to operator to climb on and off the truck, without facing any obstacles. The base lights installed inside the cabin facilitate the reading of the picking orders, even on aisles with poor lighting.

### Mast

Two-stage masts made of cold drawn profiles, for resistance to bending and twisting. The lift cylinders are installed outside of the mast profile and

the chains are protected to ensure perfect visibility and maximum safety.

### Hydraulic system

Powerful and silent lift motor fitted with electronic control able to adjust the number of revolutions of the pump, providing the appropriate amount of oil every time. All hydraulic functions are controlled by proportional solenoid valves for precise and safe load handling. Controlled cabin lifting and lowering so as to ensure smooth movement, improving the operating comfort (the relative parameters can be adjusted from the control panel).

---

## Guidance system on forks side (optional)

Driving controls positioned in front of the load



---

## Additional forks lifting

The cabin comes as standard with a built-in fork lifting system operated by buttons installed on the load side and controlled by a dedicated hydraulic motor. This way, the loading unit can be placed at optimal height every time, limiting operator fatigue. The tilting forks allow picking pallets or containers from the ground both transversally and longitudinally.



---

## New Display

The new display, connected via CAN-BUS to the truck's logic system shows information concerning not only the status of the truck, but also the status of the traction control, pump control, steering control and all of the other modules connected via the same network. You can view and configure the modules in the CAN-BUS system by connecting the control panel to the display.

## Multifunction Monojoystick

All controls (hydraulic and drive) are gathered into one multifunction ergonomic mono joystick.



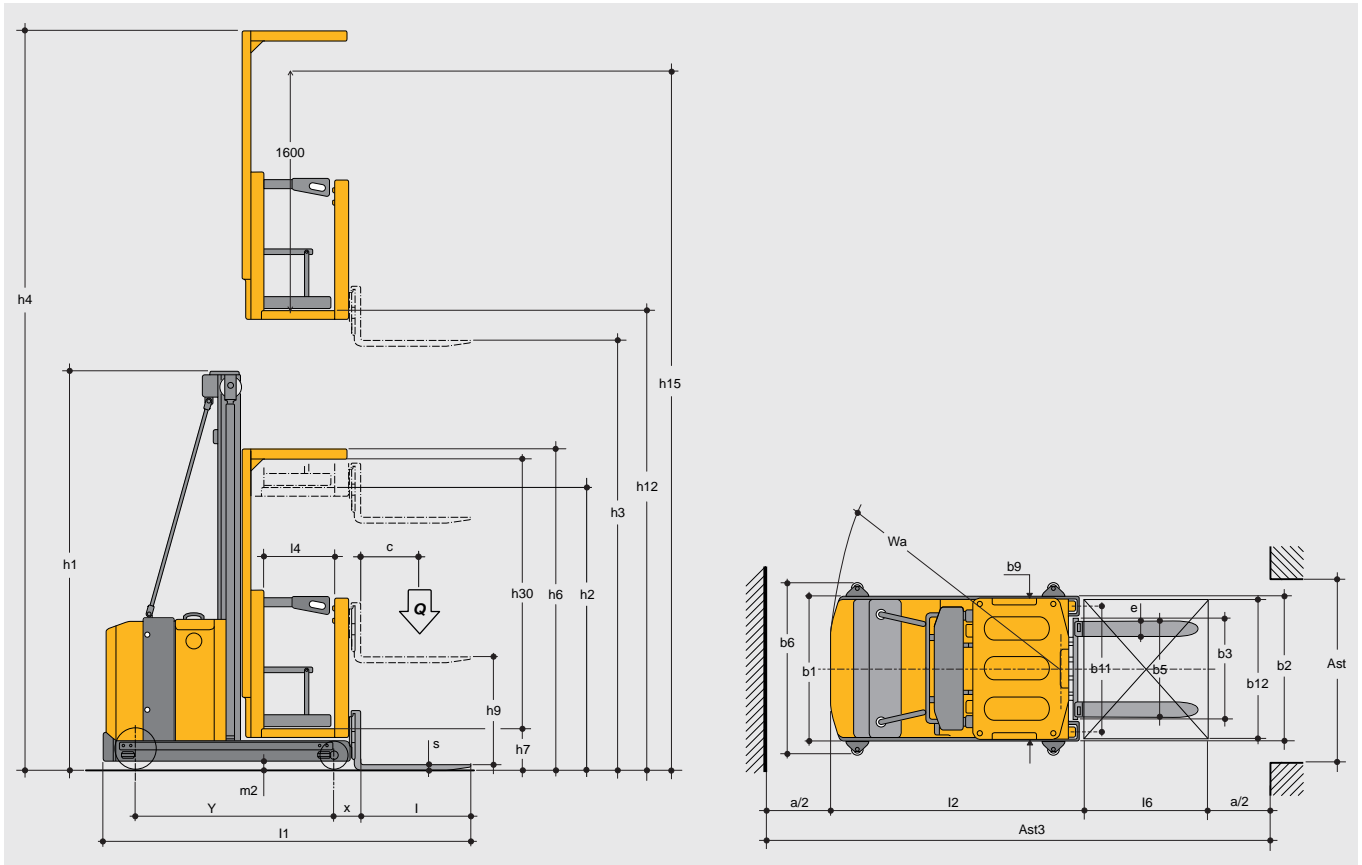

Standard masts						Q
Description	Lowered mast height	Raised platform height	Picking height	Forks lifting stroke	Extended mast height	c=600 mm
	h <sub>1</sub>	h <sub>12</sub>	h <sub>15</sub>	h <sub>3</sub>	h <sub>4</sub>	
Duplex	mm 3.140	5.000	6.600	4.720	7.040	1.0
Duplex	mm 3.640	6.000	7.600	5.720	8.040	1.0
Duplex	mm 3.890	6.500	8.100	6.220	8.540	1.0
Duplex	mm 4.140	7.000	8.600	6.720	9.040	1.0
Duplex	mm 4.390	7.500	9.100	7.220	9.540	1.0

Standard masts							Q
Description	Lowered mast height	Raised platform height	Picking height	Forks lifting stroke	Free lift	Extended mast height	c=600 mm
	h <sub>1</sub>	h <sub>12</sub>	h <sub>15</sub>	h <sub>3</sub>	h <sub>2</sub>	h <sub>4</sub>	
Triplex-GAL	mm 2.335	5.000	6.600	4.720	1.670	7.040	1.0
Triplex-GAL	mm 2.670	6.000	7.600	5.720	2.000	8.040	1.0
Triplex-GAL	mm 2.840	6.500	8.100	6.220	2.170	8.540	1.0
Triplex-GAL	mm 3.000	7.000	8.600	6.720	2.330	9.040	1.0
Triplex-GAL	mm 3.170	7.500	9.100	7.220	2.510	9.540	1.0
Triplex-GAL	mm 3.670	9.000	10.600	8.720	3.015	11.040	0.6

### Accessories and special features

servo-assisted electric steering	<input type="checkbox"/>	headlights for loads picking	<input type="checkbox"/>
steering wheel position indicator	<input type="checkbox"/>	diagonal travel	<input type="checkbox"/>
lateral battery extraction system	<input type="checkbox"/>	stop lifting device on overhead guard	<input type="checkbox"/>
simple battery extraction roller conveyor	<input type="checkbox"/>	electronic speed control	<input type="checkbox"/>
lateral guide rollers	<input type="checkbox"/>	electromagnetic parking brake	<input type="checkbox"/>
guidance and controls on forks side	<input type="checkbox"/>	voltmeter-timer, auto-lock function when 80% of the battery capacity is discharged	<input type="checkbox"/>
guide wire system 6.25 kHz +/-30 Hz	<input type="checkbox"/>	electronic braking system	<input type="checkbox"/>
frequency generator for 1,200 m of wire / 6.25 kHz	<input type="checkbox"/>	access keypad with pin code	<input type="checkbox"/>
magnet for automatic slowdown and stop at end of stroke	<input type="checkbox"/>	walk-on setup	<input type="checkbox"/>
lighting system inside the cabin	<input type="checkbox"/>		

standard  optional

Characteristics	1.1	Manufacturer			OMG S.r.l. Single member company	
	1.2	Model			904 ac	
	1.3	Operation			electrical	
	1.4	Operator position			order picking	
	1.5	Capacity	Q	t	1.0	
	1.6	Load centre of gravity	c	mm	600	
	1.8	Load distance	x	mm	122	
	1.9	Wheel centre distance	y	mm	1,611	
	Weights	2.1	Truck weight incl. battery (see line 6.5)			kg 3,975
2.2		Weight on axis with front / rear load			kg 1,912 / 3,130	
2.3		Weight on axis without front / rear load			kg 2,241 / 1,648	
Wheels Frame	3.1	Wheels and tyres			polyurethane	
	3.2	Front wheel size		mm	343x114	
	3.3	Rear wheels size		mm	200x80	
	3.5	Number of front / rear wheels (x = drive)		no.	1x / 2	
	3.6	Front track	b10	mm	/	
	3.7	Rear track	b11	mm	980	
	Base dimension	4.2	Lowered mast height	h1	mm	3,640
4.4		Forks lifting stroke	h3	mm	5,720	
4.5		Extended mast height	h4	mm	8,040	
4.7		Upper edge overhead guard height (cabin)	h6	mm	2,320	
4.8		Seat height / Platform height	h7	mm	300	
4.11		Additional lifting	h9	mm	780	
4.14		Raised platform height	h12	mm	6,000	
4.16		Platform length	l3	mm		
4.19		Overall length	l1	mm	3,130	
4.20		Length including forks heel	l2	mm	1,980	
4.21		Overall width	b1/b2	mm	1,120	
4.22		Forks size	s/e/l	mm	35 / 100 / 1,150	
4.24		Forks support plate width	b3	mm	750 - Fem 1A	
4.25		Width over forks	b5	mm	750	
4.26		Forks /transport surface internal gauge	b4	mm		
4.27		Width over guide rollers	b6	mm	variable	
4.31		Clearance under the mast	m1	mm	60	
4.32		Clearance at mid stroke	m2	mm	60	
4.33		Working aisle width with 800 x 1200 transversal pallet	Ast3	mm	3,435	
4.34		Working aisle width with 800 x 1200 longitudinal pallet	Ast	mm	1,320	
4.35		Turning radius	Wa	mm	1,865	
4.40		Picking height (h12 + 1600)	h15	mm	7,600	
4.42		Pallet width	b12	mm	800	
4.43		Pallet length	l6	mm	1,200	
4.44		Operator station width	b9	mm	1,090	
4.45		Operator station height	h30	mm	1,955	
4.46		Cabin width	l4	mm	500	
			Platform length / height / width		mm	1,090 / 1,955 / 500
Performance		5.1	Speed with / without load			km/h 8.4 / 8.5
		5.2	Lifting speed with / without load			m/s 0.26 / 0.32
	5.3	Lowering speed with/without load			m/s 0.16 / 0.20	
	5.10	Service brake			reverse	
	5.11	Parking brake			electromagnetic	
	Electric motors	6.1	Traction motor, 60 min performance with S2		kW	6
6.2		Lift motor, 15% performance with S3		kW	6	
		Lift motor, power S3 5%		kW		
6.3		Battery as per DIN 43531 / 35 / 36 A, B, C, no			no	
6.4		K5 battery voltage, nominal capacity		V/Ah	48 / 620	
6.5		Battery weight		kg	950	
Miscellaneous	8.1	Type of electronic system			AC inverter	
	8.4	Noise threshold as per EN 12 053		dB(A)	< 70	
	8.6	Electric			electrical	
					* optional	

Technical data sheet referring to pallet truck in standard version; data determined in compliance with VDI 2198. These values may differ if your product is fitted with other types of wheels and tires, supports and accessories. All data and images herein are indicative, OMG S.r.l. Single member company reserves the right to modify the documentation without prior notice.